

| | | | | | |
|----------|--|------------|----------|--|---------------|
| 版次 (Ed') | 变更摘要 (Change The Content) | 日期 (Date) | 序号 (NO.) | 品名 (Name) | 材质 (Material) |
| 0 | 新产品发行 (New Product Launch) | 2016/02/20 | | | |
| ① | 0.5双面拉拔胶芯 (H=2.0) 0.5 Pitch ZIF Double-side Type Housing (H=2.0) | | | LCP UL94V-0 本色 Natural | 1 |
| ② | 0.5双面拉拔端子 (H=2.0) 0.5 Pitch ZIF Double-side Type Terminal (H=2.0) | | | 铜合金/镀锡 Copper Alloy/ Tin Plating | |
| ③ | 0.5双面拉拔后盖 (H=2.0) 0.5 Pitch ZIF Double-side Type Actuator (H=2.0) | | | LCP UL94V-0 黑色 Black | |

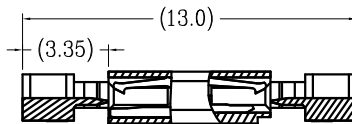
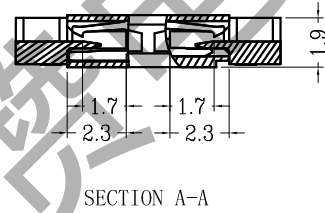
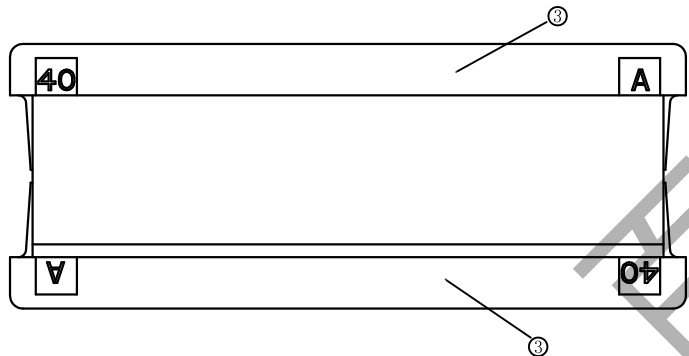
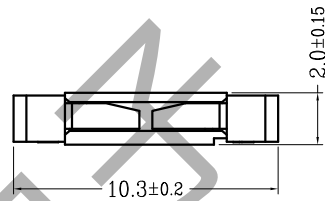
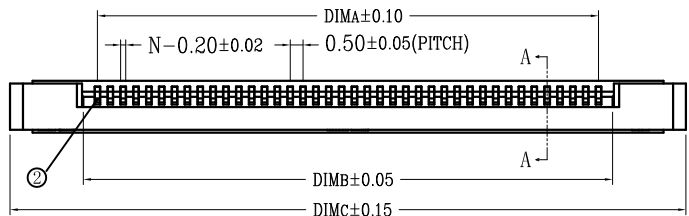
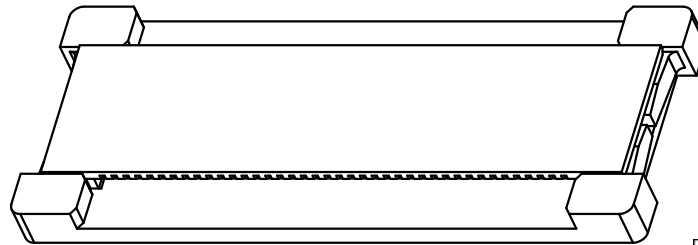
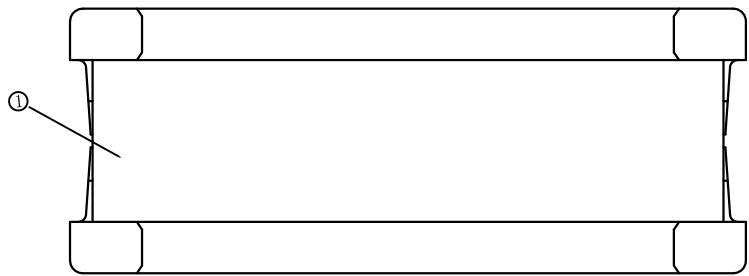

| CKT | DIM A | DIM B | DIM C | CKT | DIM A | DIM B | DIM C |
|-----|-------|-------|-------|-----|-------|-------|-------|
| 4 | 1.50 | 2.56 | 8.30 | 33 | 16.00 | 17.06 | 22.80 |
| 5 | 2.00 | 3.06 | 8.80 | 34 | 16.50 | 17.56 | 23.30 |
| 6 | 2.50 | 3.56 | 9.30 | 35 | 17.00 | 18.06 | 23.80 |
| 7 | 3.00 | 4.06 | 9.80 | 36 | 17.50 | 18.56 | 24.30 |
| 8 | 3.50 | 4.56 | 10.30 | 37 | 18.00 | 19.06 | 24.80 |
| 9 | 4.00 | 5.06 | 10.80 | 38 | 18.50 | 19.56 | 25.30 |
| 10 | 4.50 | 5.56 | 11.30 | 39 | 19.00 | 20.06 | 25.80 |
| 11 | 5.00 | 6.06 | 11.80 | 40 | 19.50 | 20.56 | 26.30 |
| 12 | 5.50 | 6.56 | 12.30 | 41 | 20.00 | 21.06 | 26.80 |
| 13 | 6.00 | 7.06 | 12.80 | 42 | 20.50 | 21.56 | 27.30 |
| 14 | 6.50 | 7.56 | 13.30 | 43 | 21.00 | 22.06 | 27.80 |
| 15 | 7.00 | 8.06 | 13.80 | 44 | 21.50 | 22.56 | 28.30 |
| 16 | 7.50 | 8.56 | 14.30 | 45 | 22.00 | 23.06 | 28.80 |
| 17 | 8.00 | 9.06 | 14.80 | 46 | 22.50 | 23.56 | 29.30 |
| 18 | 8.50 | 9.56 | 15.30 | 47 | 23.00 | 24.06 | 29.80 |
| 19 | 9.00 | 10.06 | 15.80 | 48 | 23.50 | 24.56 | 30.30 |
| 20 | 9.50 | 10.56 | 16.30 | 49 | 24.00 | 25.06 | 30.80 |
| 21 | 10.00 | 11.06 | 16.80 | 50 | 24.50 | 25.56 | 31.30 |
| 22 | 10.50 | 11.56 | 17.30 | 51 | 25.00 | 26.06 | 31.80 |
| 23 | 11.00 | 12.06 | 17.80 | 52 | 25.50 | 26.56 | 32.30 |
| 24 | 11.50 | 12.56 | 18.30 | 53 | 26.00 | 27.06 | 32.80 |
| 25 | 12.00 | 13.06 | 18.80 | 54 | 26.50 | 27.56 | 33.30 |
| 26 | 12.50 | 13.56 | 19.30 | 55 | 27.00 | 28.06 | 33.80 |
| 27 | 13.00 | 14.06 | 19.80 | 56 | 27.50 | 28.56 | 34.30 |
| 28 | 13.50 | 14.56 | 20.30 | 57 | 28.00 | 29.06 | 34.80 |
| 29 | 14.00 | 15.06 | 20.80 | 58 | 28.50 | 29.56 | 35.30 |
| 30 | 14.50 | 15.56 | 21.30 | 59 | 29.00 | 30.06 | 35.80 |
| 31 | 15.00 | 16.06 | 21.80 | 60 | 29.50 | 30.56 | 36.30 |
| 32 | 15.50 | 16.56 | 22.30 | | | | |

技术指标 (Technical Index):

- 塑件表面应光洁、无毛边、无明显收缩、缺陷、裂纹等现象 (The surface of the plastic parts should be smooth, no rough edges, no obvious shrinkage, defects, cracks and other phenomena)
- 温度范围 (Temperature range): -25° C ~ 85° C.
- 额定电压 (Rated voltage): 50V, AC/DC (等效).
- 接触电阻 (Contact resistance): ≤ 0.03Ω.
- 绝缘电阻 (Insulation resistance): ≥ 500MΩ
- 产品料号 (Product material No.):

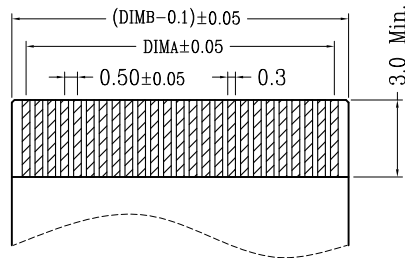

适用扁平线 (Applicable Flat Cable)

SL05200—** * *—**

NO OF CKT (产品PIN数) | 00 后盖有LOGO:WD (Actuator with LOGO:WD)
01 后盖无LOGO (Actuator without LOGO)

Plating (电镀方式) | Packing (包装方式)

1: 端子全金 (G/F OVERALL) | P: PE袋装 (Bag package)

4: 端子全亮锡
(Terminal all bright tin)



一般公差 (TOLERANCE)
X ±.50 XX ±.10
X ±.20 XXX ±.05
ANGLES ±1°

东莞市百赞电子有限公司

品名 (TITLE) 0.5 Pitch双面拉拔 (H=2.0) 0.5 Pitch H2.0 ZIF Double-side Type CONN. 制图 (DR)

料号 (DWG.NO) 校对 (CHKD)

审核 (APPD)

比例 (SCALE) 1:1 单位 (UNITS) mm 张数 (SHEET) 1 OF 1 SIZE REV A4 A