

版次 (Ed')	变更摘要 (Change The Content)	日期 (Date)
1	增加料号说明 (Add Material Number Description)	2015/1/28

序号	品名	材质
①	1. OK型胶芯 (H2.5) 1. OK Type Housing (H2.5)	LCP UL94V-0 本色 Natural
②	1. OK型上端子 (H2.5) 1. OK Type Upper Terminal (H2.5)	铜合金/表面镀锡 Copper Alloy/ Tin Plating
③	1. OK型卧式后盖 (H2.5) 1. OK Type Actuator (H2.5)	LCP UL94V-0 黑色 Black
④	1. OK型卧式焊片 (H2.5) 1. OK Type Fitting Nail (H2.5)	铜合金/表面镀锡 Copper Alloy/ Tin Plating

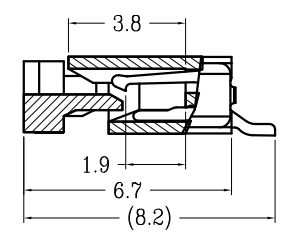

SECTION A-A

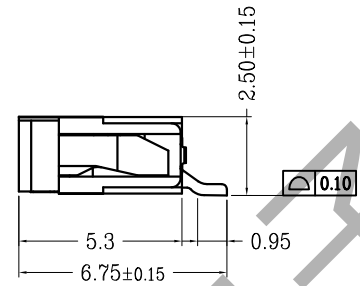
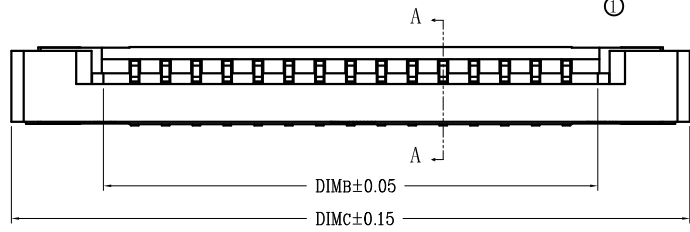
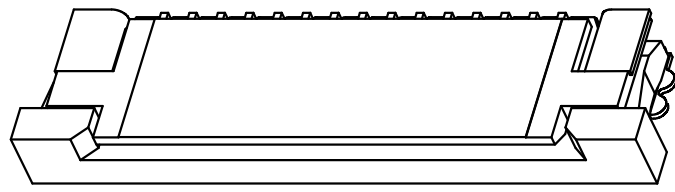
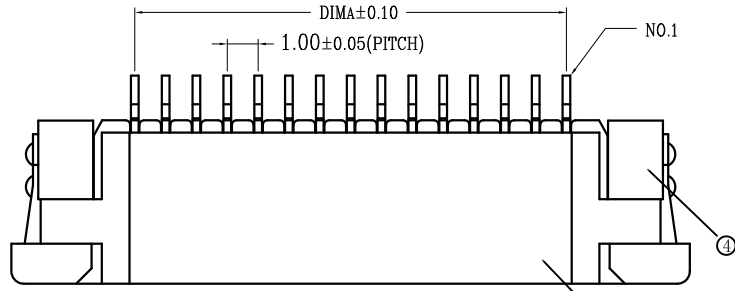
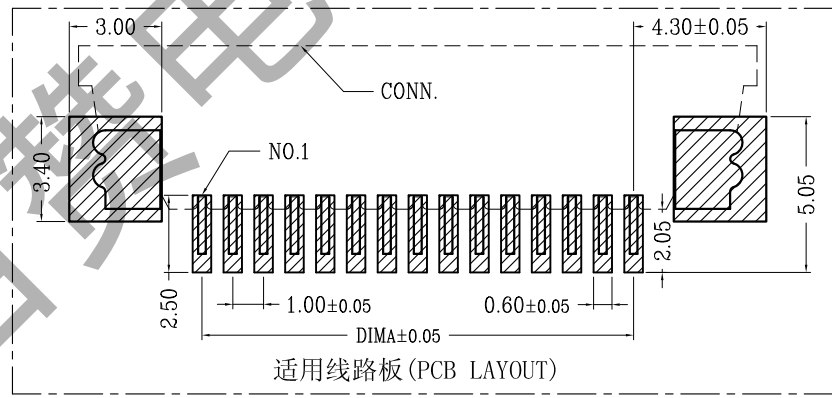
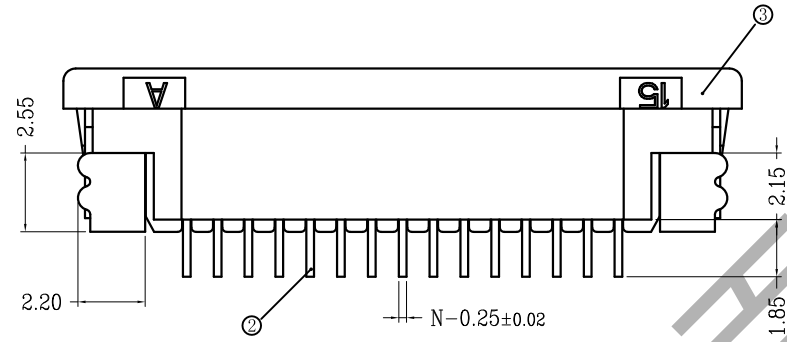

适用线路板 (PCB LAYOUT)

CKT	DIM A	DIM B	DIM C
4	3.00	5.03	11.10
5	4.00	6.03	12.10
6	5.00	7.03	13.10
7	6.00	8.03	14.10
8	7.00	9.03	15.10
9	8.00	10.03	16.10
10	9.00	11.03	17.10
11	10.00	12.03	18.10
12	11.00	13.03	19.10
13	12.00	14.03	20.10
14	13.00	15.03	21.10
15	14.00	16.03	22.10
16	15.00	17.03	23.10
17	16.00	18.03	24.10
18	17.00	19.03	25.10
19	18.00	20.03	26.10
20	19.00	21.03	27.10
21	20.00	22.03	28.10
22	21.00	23.03	29.10
23	22.00	24.03	30.10
24	23.00	25.03	31.10
25	24.00	26.03	32.10
26	25.00	27.03	33.10
27	26.00	28.03	34.10
28	27.00	29.03	35.10
29	28.00	30.03	36.10
30	29.00	31.03	37.10
31	30.00	32.03	38.10
32	31.00	33.03	39.10
33	32.00	34.03	40.10
34	33.00	35.03	41.10
35	34.00	36.03	42.10
36	35.00	37.03	43.10
37	36.00	38.03	44.10
38	37.00	39.03	45.10
39	38.00	40.03	46.10
40	39.00	41.03	47.10

技术指标 (Technical Index):

- 塑件表面应光洁、无毛边、无明显收缩、缺陷、裂纹等现象。
(The surface of the plastic parts should be smooth, no rough edges, no obvious shrinkage, defects, cracks and other phenomena.)
- 温度范围 (Temperature range): -25° C ~ +85° C.
- 额定电压 (Rated voltage): 50V, AC/DC (=等效).
- 接触电阻 (Contact resistance): ≤ 0.03Ω.
- 绝缘电阻 (Insulation resistance): ≥ 500MΩ.
- 产品料号 (Product material No.):

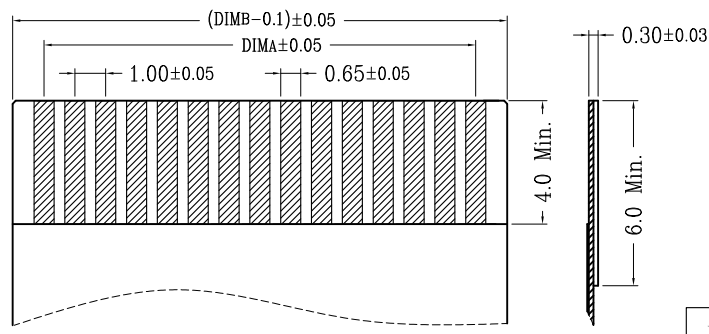

适用扁平线 (Applicable Flat Cable)

LW10251-**-**-**

00	后盖有LOGO,WD
01	后盖无LOGO
02	后盖无LOGO,焊片雾锡

NO OF CKT (产品PIN数) Packing (包装方式)

Plating (电镀方式) T: TUBE管装

0: 端子全雾锡 (Terminal all mist tin) R: TAPE & REEL卷装

1: 端子全金 (G/F OVERALL)

4: 端子全亮锡 (Terminal all bright tin)



一般公差 (TOLERANCE)
X ±0.50 XX ±1.0
X ±0.20 XXX ±0.5
ANGLES ±1°

东莞市百赞电子有限公司

品名 (TITLE)	1.0 Pitch K型卧式上接 (H=2.5) 1.0 Pitch H2.5 ZIF R/A Type Top CONN.	制图 (DR)
料号 (DWG.NO)		校对 (CHKD)
比例 (SCALE)	1:1	审核 (APPD)
单位 (UNITS)	mm	张数 (SHEET)
		1 OF 1
		SIZE
		A4
		REV
		A